

# C.I.P.

## 8 mm Rem. Mag.

Country of Origin: US

TAB. III

Date 84-06-14

Revision 08-09-23

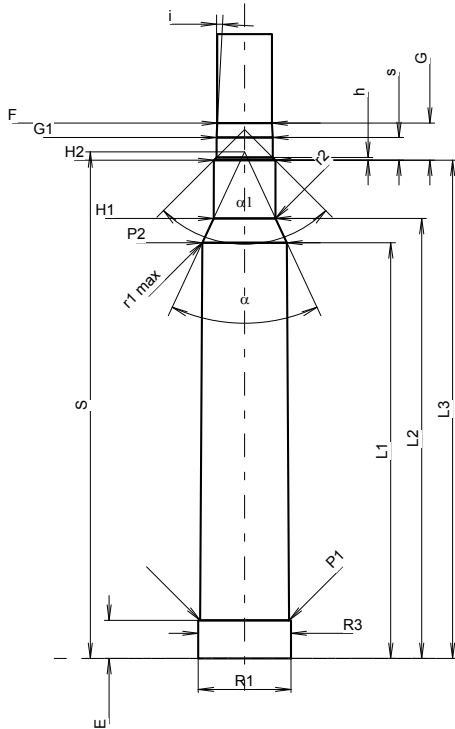
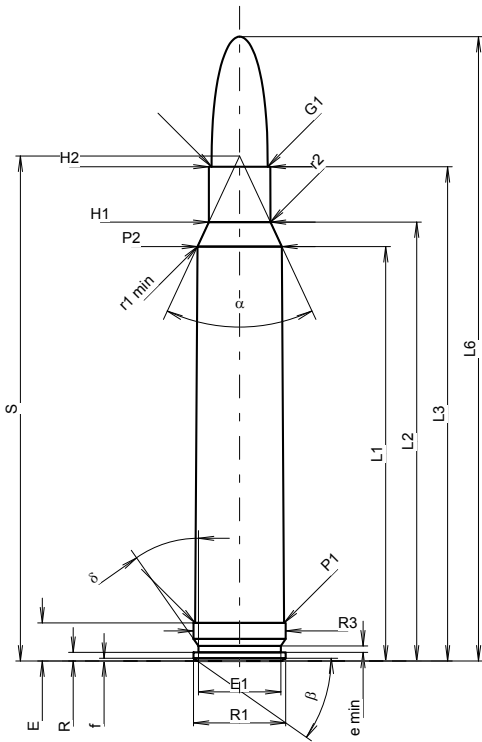

Scale 1:1.11

Dimensions in << mm >>  
Dimensions and Tolerances for Proof Barrels  
see Appendix CR 1.

### CARTRIDGE MAXI

#### Lengths

L1	=	60.69
L2	=	64.27
L3 <sup>1)</sup>	=	72.39
L4	=	
L5	=	
L6	=	91.44

#### Case Head

R	=	1.27
R1	=	13.51
R3	=	13.51
E <sup>1)</sup>	=	5.59
E1	=	12.07
e min	=	0.94
delta	=	35°
f	=	0.41
beta	=	35°

#### Powder Chamber

P1	=	13.03
P2 *	=	12.36

#### Junction Cone

alpha *	=	50°
S *	=	73.94
r1 min	=	1.02
r2	=	3.18

#### Collar

H1 *	=	9.02
H2 <sup>1)</sup>	=	8.99

#### Projectile

G1 <sup>1)</sup>	=	8.22
G2	=	
F	=	
L3+G <sup>1)</sup>	=	77.82

#### Pressures (Energies)

#### Method Transducer

Pmax	=	4400 bar
PK	=	5060 bar
PE	=	5500 bar
M	=	25.00
EE	=	5355 Joule

#### Miscellaneous Dimensions

Fe <sup>1)5)</sup>	=	0.10
delta L	=	

### CHAMBER MINI

#### Lengths

L1	=	60.88
L2	=	64.44
L3 <sup>1)</sup>	=	72.96

#### Breech

R	=	
R1	=	13.59
R2	=	
R3	=	13.59
r	=	

#### Powder Chamber

E <sup>1)</sup>	=	5.59
P1 <sup>1)</sup>	=	13.05
P2 *	=	12.39

#### Junction Cone

alpha *	=	50°
S *	=	74.17
r1 max	=	0.76
r2	=	3.81

#### Collar

H1 *	=	9.07
H2 <sup>1)</sup>	=	9.04

#### Commencement of Rifling

G1 <sup>1)</sup> *	=	8.22
G <sup>1)</sup>	=	5.43
alpha1 *	=	90°
h	=	0.41
s	=	3.33
i <sup>1)</sup> *	=	3°
w	=	

#### Barrel

F <sup>1)</sup> *	=	8.00
Z <sup>1)</sup>	=	8.20

#### Grooves

b	=	3.10
N	=	6
u	=	254.00
Q	=	52.17 mm <sup>2</sup>

Notes: 1) Check for safety reasons  
5) Headspace on Belt  
\* Basic dimensions